

## Thread turning inserts, full profile, 55°, HC5615

for female thread machining, left

**ATORN®**

### Application

For creating male threads on CNC machines for the material groups of steel, stainless steel, non-ferrous metal and cast iron at low to medium cutting speeds.

### Version

- ground thread turning insert with TiN coating

### Advantage

- ground thread turning insert, ensures good finish quality, cutting precision and thread with precise profile replication
- wide range of applications thanks to TiN coating
- high level of productivity and no need to deburr the thread

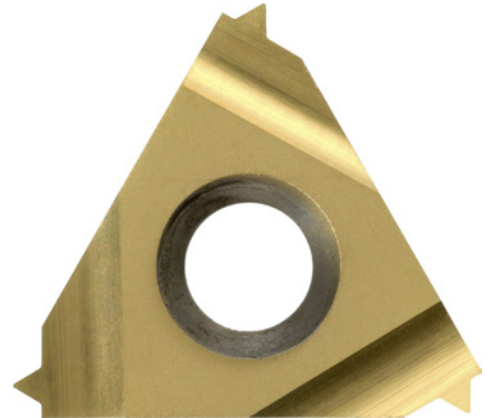

<b>Art. no.</b>	<b>17743 708</b>
<b>ISO name</b>	16 (IR/IL) 11W
<b>Number of thread starts per inch</b>	11
<b>Machining direction</b>	Left
<b>Carbide type</b>	HC5615
<b>Min./max. Vc in steel</b>	75-110 m/min
<b>Min./max. Vc in stainless steel</b>	70-75 m/min
<b>Min./max. Vc in non-ferrous metals</b>	200-600 m/min
<b>Min./max. Vc in cast iron</b>	70-80 m/min

### EAN-Code

4050293237702