

Fixed centring point

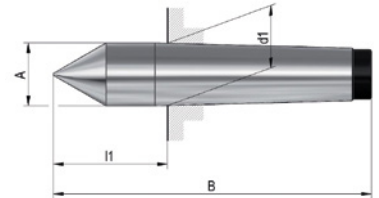

Execution

- Full tip
- Tip angle 60°
- Fully hardened and ground
- Tool steel



Technical Data

Product number	1024110 102
Morse taper size	MK 1
Diameter	12.065 mm
Length	80 mm
Programming size	26.5 mm
Outer diameter	12.2 mm
Concentricity tolerance	0.003 mm
Manufacturer Part Number	491325
EAN Code	4019208488066
Commodity Code	84662091



Hommel Hercules Werkzeughandel GmbH & Co. KG

Heidelberger Str. 52 | 68519 Viernheim | +49 (0) 6204 739-0 | info@hommel-hercules.com