

Fixed centring point

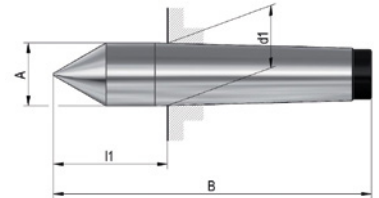

Execution

- Full tip
- Tip angle 60°
- Fully hardened and ground
- Tool steel



Technical Data

Product number	1024110 103
Morse taper size	MK 2
Diameter	17.78 mm
Length	100 mm
Programming size	36 mm
Outer diameter	18 mm
Concentricity tolerance	0.003 mm
Manufacturer Part Number	491323
EAN Code	4019208488073
Commodity Code	84662091



Hommel Hercules Werkzeughandel GmbH & Co. KG

Heidelberger Str. 52 | 68519 Viernheim | +49 (0) 6204 739-0 | info@hommel-hercules.com