

Fixed centring point

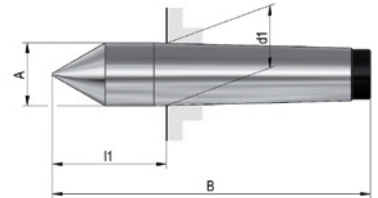

Execution

- Full tip
- Tip angle 60°
- Fully hardened and ground
- Tool steel



Technical Data

Product number	1024110 105
Morse taper size	MK 4
Diameter	31.267 mm
Length	160 mm
Programming size	57.5 mm
Outer diameter	31.6 mm
Concentricity tolerance	0.003 mm
Manufacturer Part Number	491327
EAN Code	4019208488097
Commodity Code	84662091

